

Pineapple End Cutter CEX

The Pelamatic pineapple end cutter makes it possible to leave the fruit ready for immediate peeling with little effort, becoming a very practical accompaniment to Pelamatic pineapple peelers. Its design allows the waste to be extracted in a single blow, which makes it highly useful for pineapple peeling processes.

Our end cutter comes with a special stainless steel reinforcement to keep the piece immobile and facilitate cutting, avoiding wasted time and making the most of the fruit.

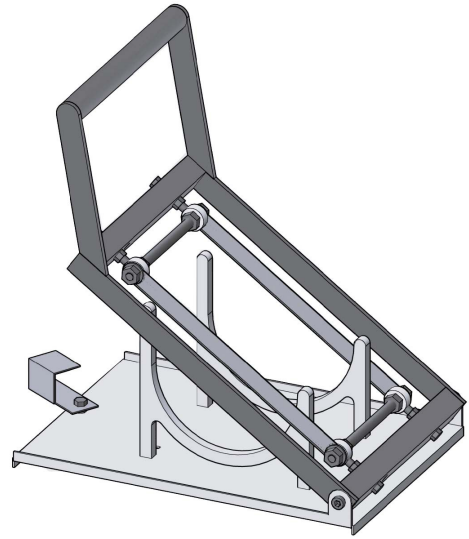

General characteristics

- Strong, fast and efficient.
- Manual machine.
- Allows quick and safe cleaning by using warm water and a cloth. Recommended daily cleaning.
- Two pieces of stainless steel for a good hold of the fruit.
- Designed with a stainless steel structure.
- Advisable to facilitate the peeling processes in Pelamatic pineapple peelers.
- Light and easily transportable.

Technical characteristics

| | | | |
|--------------|--|----------------|--|
| Productivity | 12 units/min aprox. | Net weight | 3.7 kg |
| Dimensions | Closed: 395 x 145 x 220 mm Open: 395 x 410 x 220 mm | Blade distance | CEX-102: 102 mm CEX-119: 119 mm |
| Fruit size | 150 mm aprox. | Material | 304 stainless steel |

* Spare parts available